

Recommended End Hooks - All Grades

Soft Metric Size	mm				Imperial Size	inches					
	D	90° Hooks		180° Hooks		D	90° Hooks		180° Hooks		
		A or G	A or G	J			A or G	A or G	J		
10	60	150	125	80	3	2.25	6	5	3		
13	80	200	150	105	4	3.00	8	6	4		
16	95	250	175	130	5	3.75	10	7	5		
19	115	300	200	155	6	4.50	12	8	6		
22	135	375	250	180	7	5.25	14	10	7		
25	155	425	275	205	8	6.00	16	11	8		
29	240	475	375	300	9	9.50	19	15	11.75		
32	275	550	425	335	10	10.75	22	17	13.25		
36	305	600	475	375	11	12.00	24	19	14.75		
43	465	775	675	550	14	18.25	31	27	21.75		
57	610	1050	925	725	18	24.00	41	36	28.5		

*H dimension is approximate

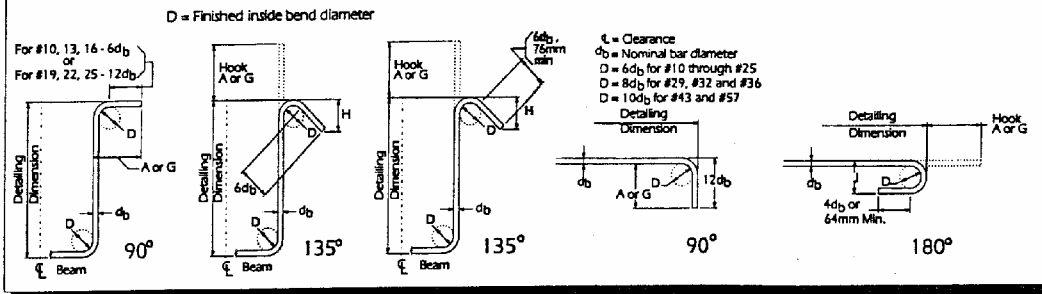

Stirrup and Tie Hooks - All Grades (General)

Soft Metric Size	mm				Imperial Size	inches					
	D	90° Hooks		135° Hooks		D	90° Hooks		135° Hooks		
		A or G	A or G	H approx			A or G	A or G	H approx		
10	40	105	105	65	3	1.50	4	4	2.5		
13	50	115	115	80	4	2.00	4.5	4.5	3		
16	65	155	140	95	5	2.50	6	5.5	3.75		
19	115	305	205	115	6	4.50	12	8	4.5		
22	135	355	230	135	7	5.25	14	9	5.25		
25	155	410	270	155	8	6.00	16	10.5	6		

Stirrup and Tie Hooks - All Grades (Seismic)

Soft Metric Size	mm			Imperial Size	inches		
	D	135° Seismic			D	135° Seismic	
		A or G	H approx			A or G	H approx
10	40	110	80	3	1.50	4.25	3
13	50	115	80	4	2.00	4.5	3
16	65	140	95	5	2.50	5.5	3.75
19	115	205	115	6	4.50	8	4.5
22	135	230	135	7	5.25	9	5.25
25	155	270	155	8	6.00	10.5	6